

2100 FORREST PARK ROAD
 ATLANTA, FULTON COUNTY, GEORGIA 30315
 INDUSTRIAL SITE
 WITH POTENTIAL RAIL ACCESS

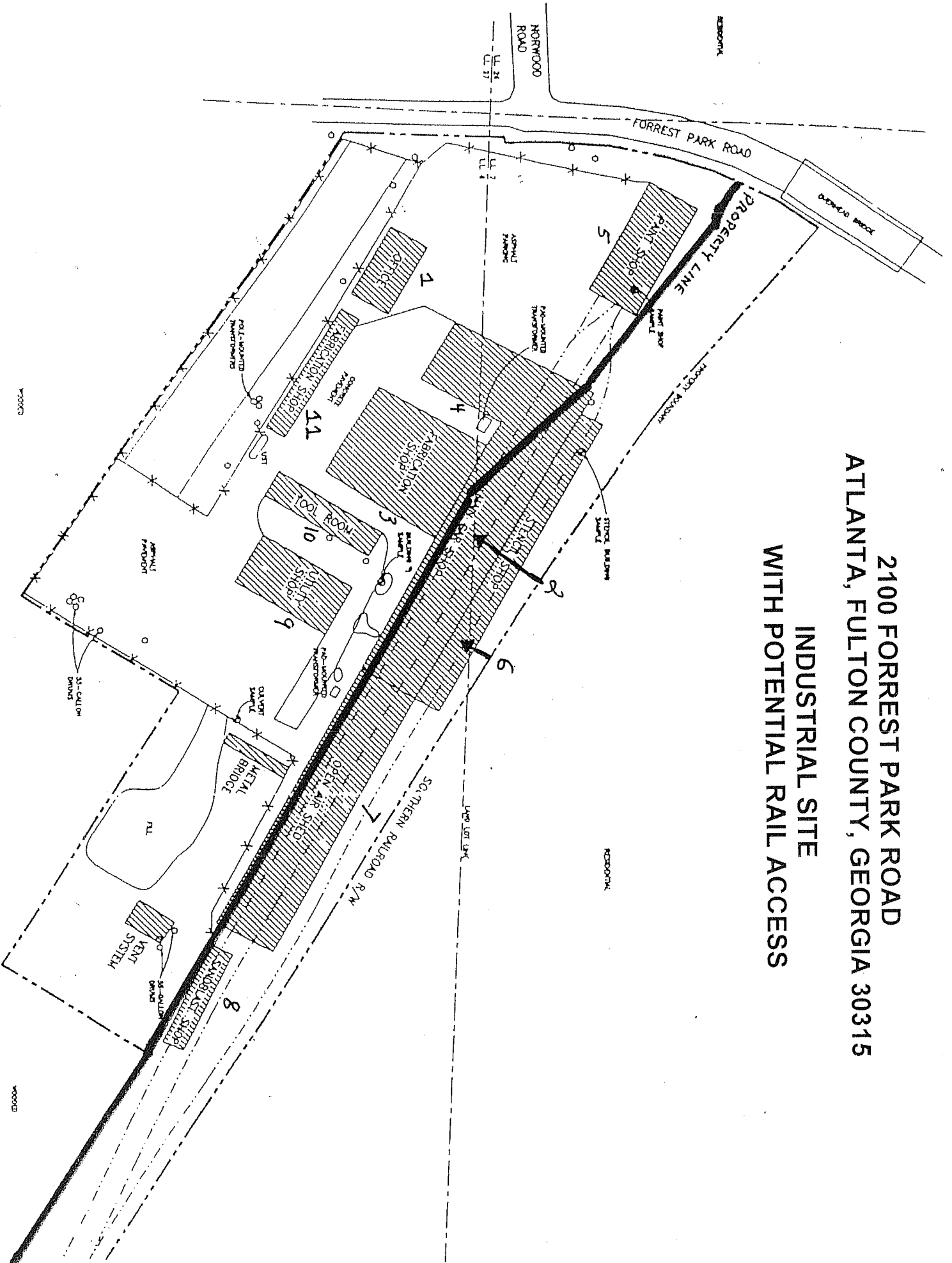

2100 FORREST PARK ROAD
 Atlanta, Fulton County, GA 30315
 Industrial Site With Potential Rail

SPERRY VAN NESS
 3300 Holcomb Bridge Road, S-250
 Norcross, GA 30092
 770-209-1700 770-300-0507 fax

BLDG	YR BUILT	CONSTR	ROOF	NAME	SQ FT RAILROAD	SQ FT LANDLORD	TOTAL SQ FT	DRIVE IN	CEILING	COLUMNS	RAIL	CRANE	OTHER
1	1970	Metal/Steel	Metal	Office	0	3,080	3,080	Five private offices, reception, work area, conference room, rerstrooms, kitchen, copy room and storage room.					
2	1970	Metal/Steel	Metal	Main Car Shop	11,055	8,375	19,430	4 @ 16' x 22'	30' - 33'	24' x 30'	Yes	1 @ 20 ton 20' hook	Vented utility floor
3	1970	Metal/Steel	Metal	Fabrication Shop 1	0	11,834	11,834	1 @ 14' x 22'	20' - 24'	24' x 50'	No	1 @ 5 ton 13' hook 1 @ 5 ton 12' hook	Mezz office, locker room & showers
4	1970	Metal/Steel	Metal	Fabrication Shop 2	0	6,164	6,164	4 @ 10' x 10'	10' - 16'	24' x 24' & 24' x 35'	Yes		
5	1970	Metal/Steel	Metal	Paint Shop	0	6,000	6,000	1 @ 10' x 10' 1 @ 16' x 22' 1 @ 24' x 22'	23' - 24'	None	Yes	No	Compressed air lines
6	1970	Metal/Steel	Metal	Stencil Shop	7,775	0	7,775	2 @ 16' x 22'	24' - 26'	None	Yes	No	Compressed air lines
7	1970	Metal/Steel	Metal	Open Air Shed	13,205	3,475	16,680	None	21' - 23'	28' x 25'	Yes	1 @ 1 ton monorail	Open shed
8	1970	Metal/Steel	Metal	Sand Blast Shop	2,205	0	2,205	2 @ 14' x 22'	24'	None	Yes		
9	1970	Block	Metal	Utility Shop	0	5,000	5,000	None	16' - 18'	None	No		3 offices & shower
10	1970	Block	Metal	Tool Room	0	3,042	3,042	1 @ 8' x 8'	12'	None	No	No	1,611 SF is shed
11	1970	Metal/Steel	Metal	Fabrication Shop 3	0	2,961	2,961	4 @ 10' x 20'	11'	None	No	3 @ 1 ton 8' hook	
Total					34,240	49,931	84,171						